

|                |                     |            |                        |
|----------------|---------------------|------------|------------------------|
| PRODUCT CODE:- | <b>KLS-5 Series</b> | CATEGORY:- | <b>Key Lock Switch</b> |
|----------------|---------------------|------------|------------------------|

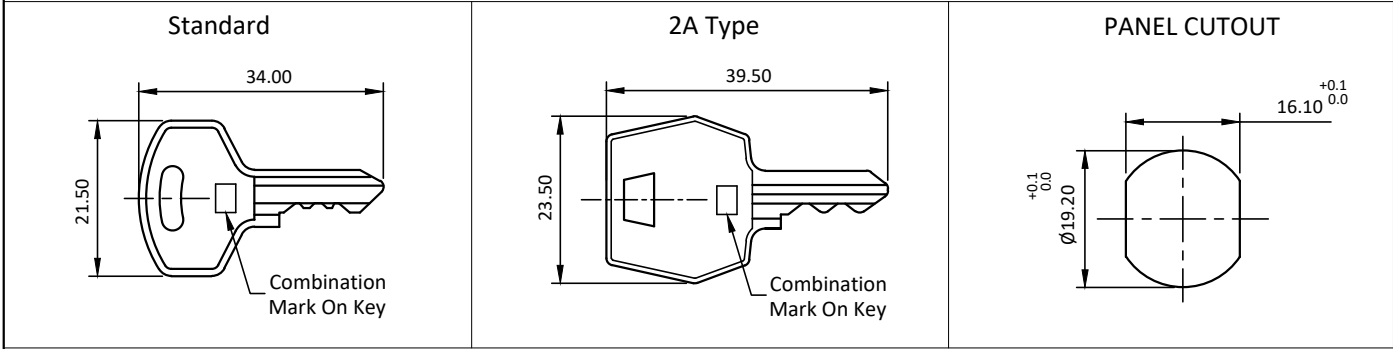
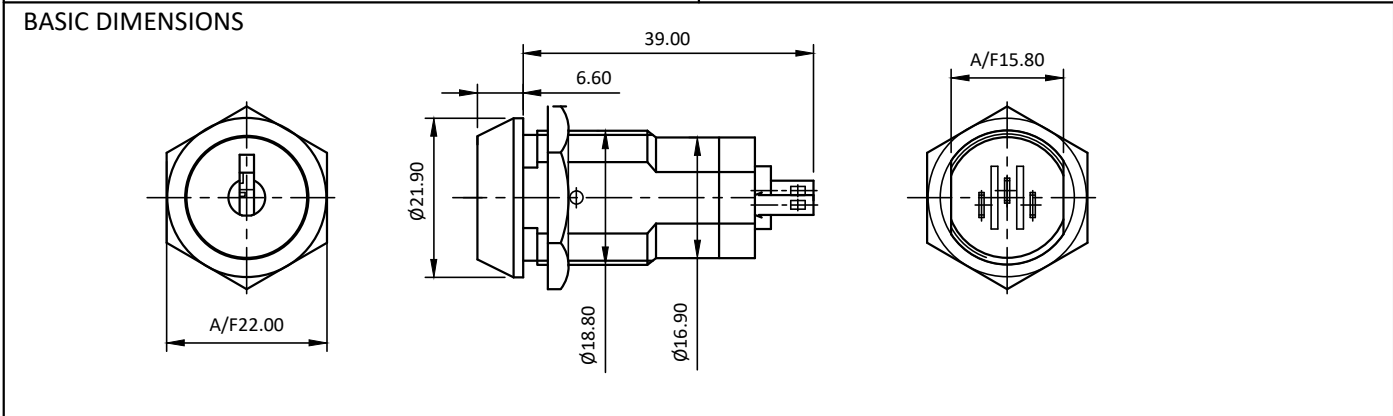

**SPECIFICATION TABLE**

| SR.NO. | PARAMETER                           |                       | SPECIFICATION                            |
|--------|-------------------------------------|-----------------------|--|
| 1      | Switch type                         |                       | Key operated, SPDT                       |
| 2      | V/A Rating                          |                       | 3A 250VAC, 1A 24VDC                      |
| 3      | Contact Resistance (Initial)        |                       | 10m Ohms Max.                            |
| 4      | Insulation Resistance At 500 V DC   |                       | 100M Ohms Min.                           |
| 5      | H.V. Break Down Test (For 1-Minute) |                       | 1KV AC                                   |
| 6      | Mounting                            |                       | Panel With Screw                         |
| 7      | Electrical life                     |                       | 10,000 Cycles Min.                       |
| 8      | Terminals                           |                       | Solder-type                              |
| 9      | Permissible Temp.                   | (a) With/Without Load | -25°C TO +85°C.                          |
|        |                                     | (b) For Soldering     | 270°C, 5 Sec. Max.                       |
| 10     | Material                            | (a) Body              | Mazak                                    |
|        |                                     | (b) Terminals         | Copper, Silver Plated.                   |
|        |                                     | (c) Contacts          | Silver & Copper, Silver plated           |
| 11     | Reference Standard                  |                       | IEC-61058-1 , UL-1054                    |
| 12     | Compliance Marking                  |                       | (On request, Please refer ordering code) |

**ORDERING CODE**

| Series | Key Removable |                 | Key Type  |                    | Approvals |                   |
|--------|---------------|-----------------|-----------|--------------------|-----------|-------------------|
| KLS-5  | A             | In One Position | No Suffix | Standard           | No Suffix | Without Approvals |
|        | AB            | In Two Position | 2A        | Variety On request | V         | CE, RoHS          |

For Example - KLS-5A  
KLS-5AB2AV

|                |     |     |              |  |              |            |          |                 |  |
|----------------|-----|-----|--------------|--|--------------|------------|----------|-----------------|--|
|                |     |     |              |  |              | APP        |          | PBM             | Plot E-4, Kagal Five Star MIDC, Kagal, Kolhapur, MH - 416236, India<br>Elcom International Pvt. Ltd.<br>www.elcom-in.com |
|                |     |     |              |  |              | CHK        |          |                 |  |
|                |     |     |              |  |              | DRN        | 10.01.04 | SNV             |  |
| REV            | IS  | WAS | DATE         | SIGN   | APP.         | BY         | DATE     | SIGN            |  |
| UNSP.TOLERANCE |     |     | DIMNS. IN mm | WT(Gm) Max.  | SCALE:- NTS. | PROJECTION | SHEET    | DRAWING NUMBER  |  |
| OVER           | -   | 1   | 10           | Moulding, plating details as per Bill of Material<br>Unspecified colour is Black, GF:Glass filled. |              |            | 1 OF 1   | P K L S 2 0 0 5 | REVISION   |
| UP TO          | 1   | 10  | -            |  |              |            |          |                 | 0  |
| ±              | 0.2 | 0.3 | 0.5          |  |              |            |          |                 |  |